



**ST PAUL
LUTHERAN SCHOOL**

Living and Learning Together in Christ

inspire

2020 WELCOME EDITION

Upcoming Events

TERM 1, WEEK 1

MON 27 JANUARY

- Australia Day Public Holiday

TUE 28 JANUARY

- Pupil Free Day

WED 29 JANUARY

- Term 1 Commences (Years 1-6)
- Opening Chapel

WED 29 - MON 3 FEBRUARY

- Reception School Visits

SUN 2 FEBRUARY

- Blessing of the Backpacks Service 9:30am

WEEK 2

TUE 4 FEBRUARY

- Reception Students First Day

WED 5 FEBRUARY

- Installation of Student Leaders
- Parent Information Evening, Yrs 1, 4 & 5

THURS 6 FEBRUARY

- Parent Information Evening, Yrs 2, 3 & 6

FRI 7 FEBRUARY

- Welcome New Families Celebration

WEEK 3

TUE 11 FEBRUARY

- School Tour 9:30pm

Greetings Parents and Caregivers,

Welcome to all of you for 2020!

This publication, Inspire, is our weekly communication to families. Beginning next week, Inspire will be emailed as a link to our website weekly on Wednesdays. You can access current and past issues of Inspire on our website. I ask that you please read the information contained in this document each week as it always contains relevant and important information, from weekly events and requirements, to long-term school strategic planning.

In our 2020 Welcome Edition we have included important information to assist you for the beginning of the year.

Should you have any questions or concerns, please do not hesitate to contact the school office.

We look forward to working with you and your children as they continue to grow, explore, inquire, and learn this year.

I pray that you, being rooted and established in love, may have power, together with all the Lord's holy people, to grasp how wide and long and high and deep is the love of Christ.

Ephesians 3:17-18

Leila Mattner | Principal



From the Principal

STAFFING NEWS

St Paul is delighted to welcome the following new staff this year:

Karly Bartlett	PE Teacher
Hayley Woodward	Year 5 Classroom Teacher
Shenae Putz	Administration Assistant

In addition to this news, I'd like to share that I will be taking some leave in the coming months. After the school year begins, I will be taking a Term of leave from February 10, (Week 3 of Term 1) through to Week 3 of Term 2. This will be a chance for me to be 'Mum' for several weeks, as well as to take some Sabbatical leave. In my absence, Mr Jason Fay will take the role of Acting Principal.

From the Deputy Principal

We look forward to an exciting year at St Paul and welcoming all of our students and families, new and old, back to school.

One of the new developments over the summer that will be immediately noticeable, is the new location of the library. This is now situated in what has previously been known as 'the creative space', in the very heart of the school. The old library space will become a staff work space for planning and professional development.

This move has taken place for a number of reasons but in short, this is about highlighting the indispensable role of the library in the life of the school. Wendy McLeod does an amazing job of promoting reading and the joy of books to students, but the previous location of the library, upstairs at the far end of the school, restricted when and how this has occurred.

Teachers have devoted much time to the pedagogy of reading over the last two years and this will continue this year. Moving the library to a more central position allows easier, more frequent access, not just for whole classes but for individual students. It also increases incidental contact with Wendy and the library collection.

I urge you to prioritise a time over the first week or so of school to visit the new library space with your children and introduce yourself to Wendy. The new location provides an opportunity for this to happen at drop off and pick up times quickly and conveniently. The most important reason for the move, is you, the families of our school. In conversation with Wendy when we were weighing up the move, she mentioned that she could count the amount of parents who visited the library in 2019, on one hand.

The role of parents in developing reading skills in children is obvious. Encouraging reading at home and before bedtime is the role of the family and research tells us that it has an impact on achievement. We want to increase the incidental contact of parents with Wendy and the library collection. This will allow families to discuss authors and new books, appropriate reading levels and borrow books together for family reading time. This will not only assist with the reading level or ability of your child, but most importantly, cultivate their love and joy of reading.



ST PAUL LUTHERAN SCHOOL STAFF FOR 2020

- Mrs Leila Mattner (Principal)
- Mr Jason Fay (Deputy Principal)
- Miss Carly Bergen (Wellbeing and Administration Leader)
- Miss Erin Gracey (Reception Teacher)
- Mr Henry Sheedy (Reception Teacher)
- Miss Stacey Baldock (Year 1 Classroom Teacher)
- Miss Carly Lethborg (Year 1 Classroom Teacher)
- Mrs Nicole Tew (Year 2 Classroom Teacher)
- Mrs Karly Voigt (Year 2 Classroom Teacher)
- Mrs Rachael Saint (Year 2 Classroom Teacher)
- Mrs Claire Sheridan (Year 2 Classroom Teacher)
- Mrs Katie Jeffery (Year 2 Classroom Teacher)
- Ms Megan Fyffe (Year 3 Classroom Teacher)
- Miss Claire Fisher (Year 3 Classroom Teacher)
- Miss Emma Arnold (Year 3 Classroom Teacher)
- Miss Rebecca Mueller (Year 4 Classroom Teacher)
- Miss Amber McMahon (Year 4 Classroom Teacher)
- Miss Hayley Woodward (Year 5 Classroom Teacher)
- Miss Tania Burgan (Year 5 Classroom Teacher)
- Miss Bec Mattner (Year 6 Classroom Teacher)
- Miss Jessica Robinson (Year 6 Classroom Teacher)
- Mrs Danielle Nak (Inclusive Education Leader)
- Miss Karly Bartlett (Physical Education Specialist Teacher)
- Mr Armin Mayer (German/Digital Technologies)
- Mrs Marlise Janetzki (Performing Arts Teacher)
- Miss Rebecca Heinjus (SPLASH Director)
- Ms Wendy McLeod (Librarian)
- Mrs Jane Sabel (Uniform Shop Manager)
- Mrs Chris Semmler (Canteen Manager)
- Mrs Sherri McPherson (Administration Assistant)

- Mrs Jessica Deer (Administration Assistant)
- Miss Shenae Putz (Administration Assistant)
- Mrs Monique Tabuena (Finance Assistant)
- Mrs Natalie Broome (Leadership Support / Registrar)
- Mrs Louise Venning (School Ministry Worker/Community Chaplain)
- Miss Cheryl Ziegeler (Learning Support)
- Mrs Beth Madigan (Teacher Assistant)
- Mrs Joanna Wilson (Teacher Assistant)
- Ms Dianne Brown (Teacher Assistant)
- Mrs Sue Helps (Teacher Assistant)
- Mrs Joyleen Mead (Teacher Assistant)
- Mrs Lorraine Griffin (Cleaning Staff)
- Mr Ian Voigt (Cleaning Staff/Groundsperson)
- Mr John McCann (Cleaning Staff)

Learn, save, grow!

Teach children how to save, before they learn to spend, with an LLL Children's Savings Account.

Featuring:

- No fees or charges – at all
- Great interest rate with no 'bonus' rate hurdles to jump
- Funds always accessible
- No minimum deposit or balance required
- Easy to follow passbook with internet access available.

Cash deposits can be made into your child's account via school banking available at this school - **ask the School office how.**

Use promo code **GET25** limited time only

For more information or to open an LLL Children's Savings Account:

www.lli.org.au
Phone our office on 1800 556 456

Children's Account

Learn, save, grow.

This advice is general in nature and does not take into account your personal situation, needs or objectives. Please refer to the Disclosure Documents before making a decision to deposit funds with the LLL. *The \$25 gift consists of the normal \$5 gift paid into the first account opened in the child's name, PLUS an additional \$20 when quoting the promotional code (GET25) and the account is opened by 31 March 2020.



STUDENT MEDICATION HELD AT SCHOOL

An **Administration of Medication Authority** form was sent home with your child's medication on the last day of Term 4, 2019. Please ensure this is filled out and returned with any medication on the first day of Term 1, 2020. This is a new procedure which will be ongoing whenever medication is required to be administered to your child. Please ensure that a current Asthma plan, signed by your GP is also attached with any Asthma medication.

BACKPACK BLESSING

On Sunday February 2 at 9:30am, St Paul Lutheran Church, we will be sending all our school staff and students back to school with prayers and blessings. All students of any age are encouraged to bring their school bag for a special blessing to start the year ahead. At this service, new staff members will be installed and all staff will take part in a dedication for 2020.

RECEPTION STUDENTS' FIRST DAY

Throughout the first week of school for Years 1-6, our Reception students and parents will be meeting with their teachers and other class members, ready to commence in Week Two of the Term. Our first day for Reception students will be on Tuesday 4 February. All Reception parents are invited to join us in the courtyard outside the uniform shop for morning tea after they have dropped their excited children to the classroom. Please join us to celebrate or debrief with us and to grab some caffeine before continuing your day!

TIMETABLE CHANGES 2020

After feedback from families, staff and students during 2019, we have made some changes to the school timetable for 2020. We will continue to have the longer play time earlier in the day so students are outside during the cooler part of the day, but this time is now half an hour later. Class teachers will determine their own 'break/fruit break' depending on their own class schedule before the first Morning Break.

8:30am - Children arrive at school

8:45am - Lessons commence

9:00-9:45am - Lesson 1

9:45-10:30am - Lesson 2

10:30-11:15am - Lesson 3

11:15-12:00pm - Morning Break

12:00-12:45pm - Lesson 4

12:45-1:30pm - Lesson 5

1:30-2:00pm - Afternoon Break

2:00-2:45pm - Lesson 6

3:15pm - School day ends

The change in the school day allows for a greater amount of teaching time in the morning, when students are at their best to learn and this maximises the time our LSO staff are here.

MUSIC LESSONS

All instruments apart from piano are available via Learning Through Music. These can be arranged through Susan at 0401398120 or info@ltmusic.com.au. Tina Hill will continue the piano program and she can be contacted at tinahill00@gmail.com or 0421 186 970.



WELCOME TO ST PAUL CELEBRATION

SAVE THE DATE

*Friday 7th February 2020
From 3:30pm*

Under the cover by nature play

See you there!



St Paul Lutheran School

2/3
Up to
Year 2/3

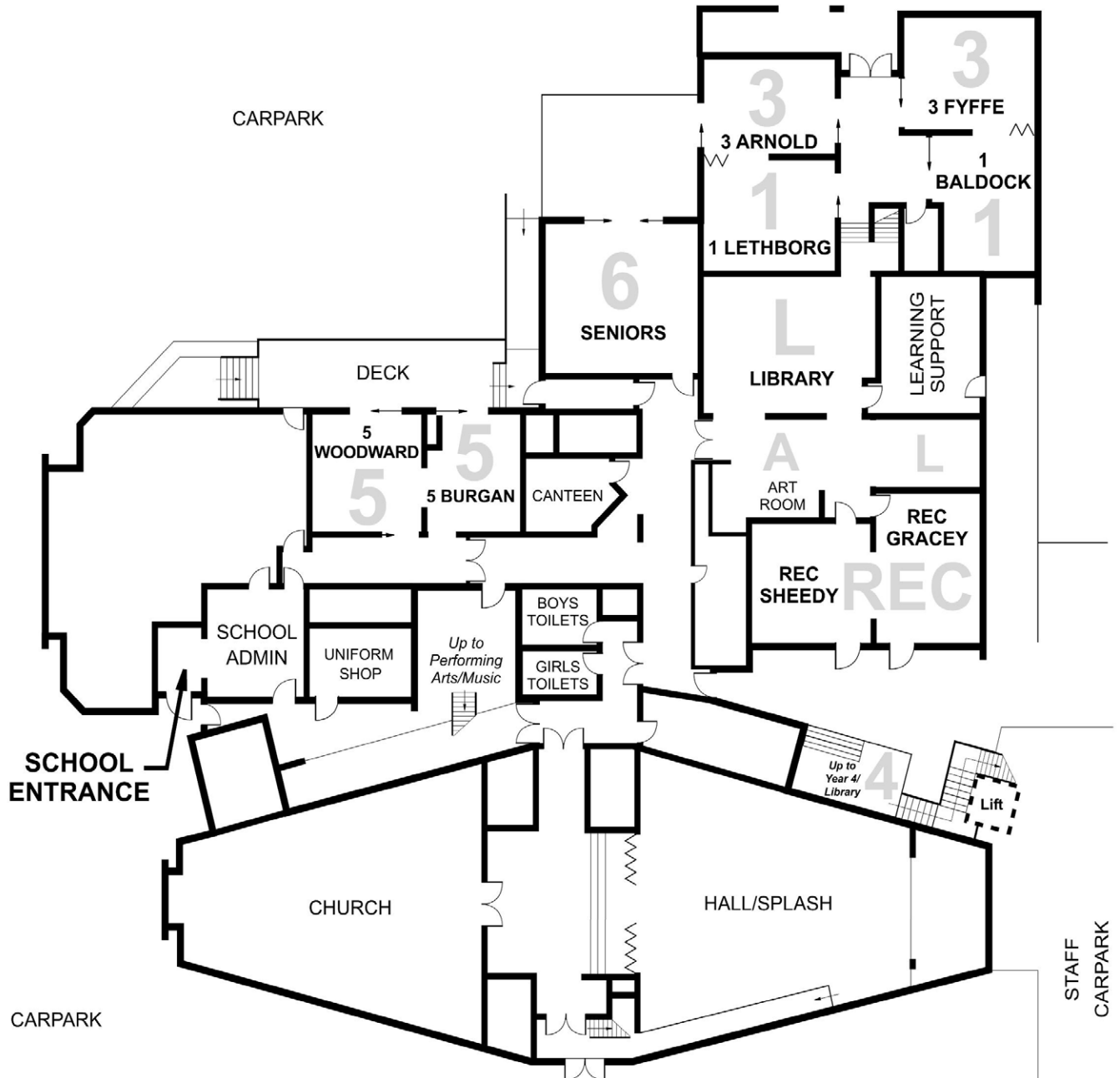

AUDREY AVENUE

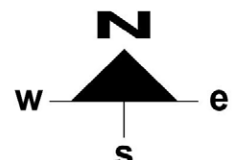

St Paul Lutheran School

UPPER SCHOOL LEVELS

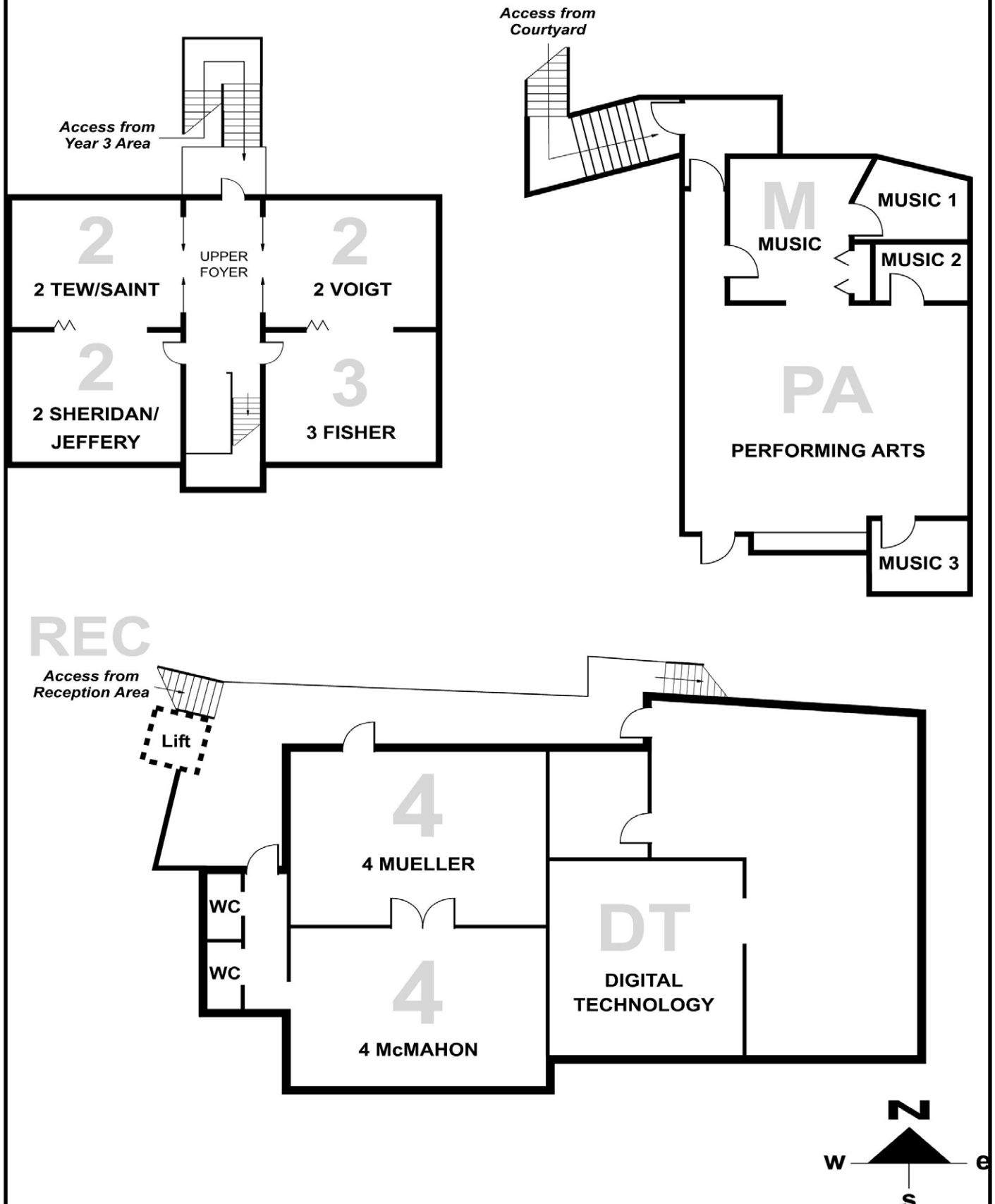

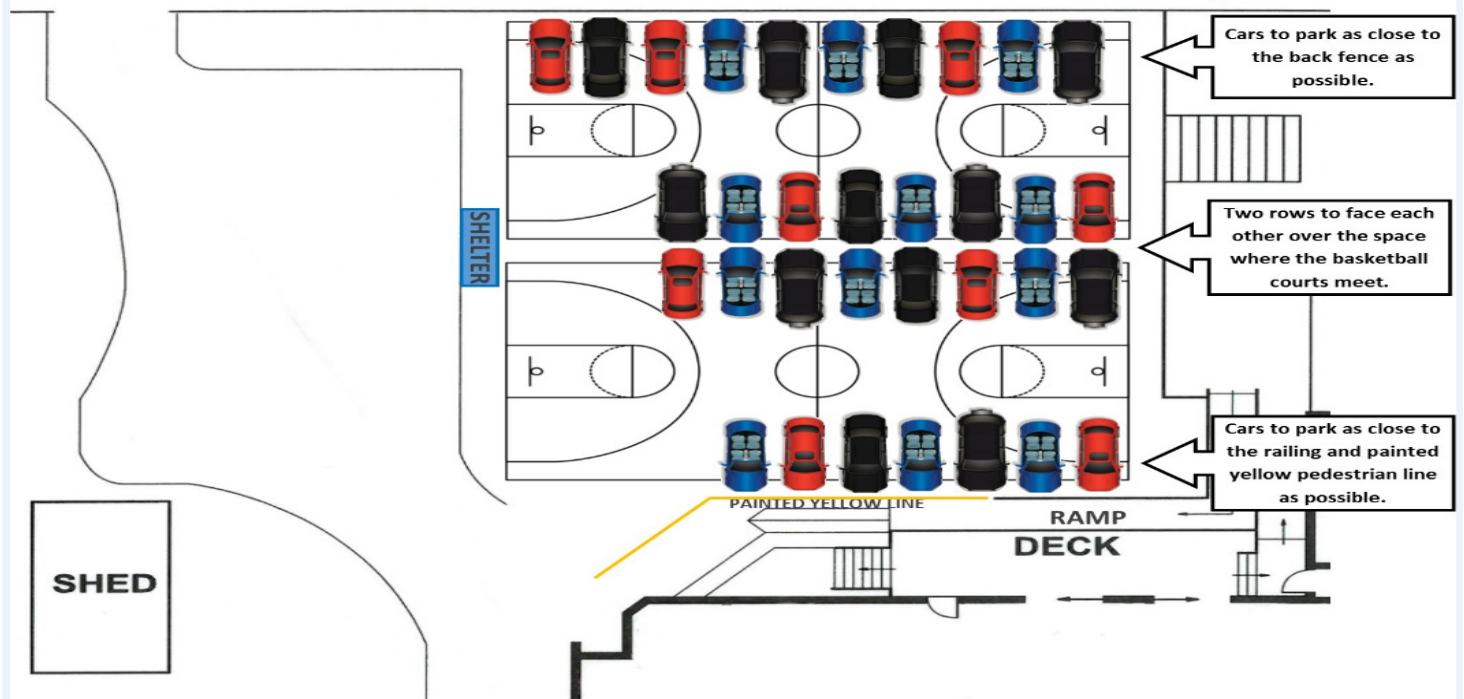

TRAFFIC MOVEMENT AT ST PAUL

To assist us with the safe and timely movement of all traffic around the school, please help us with the following considerations. Sharing this with grandparents and other family members who assist with the school drop off and pick up will also assist.

- Park and walk into school wherever possible, as this greatly reduces traffic congestion.
- Remain vigilant with your child/ren while crossing roads or within the carpark area. Use the crossings.
- Children entering and exiting the 'Kiss and Drop' without the need for parents to exit the vehicle whenever possible. The Kiss and Drop driveway is for children who do not need parents assistance entering or exiting vehicles. Parents, please stay in your cars to keep traffic moving. This will be a significant aid in speeding up traffic.
- There is no overtaking when using the 'Kiss and Drop' queue.
- Please ensure you follow the direction of staff that are entrusted to move children and parents in/out of the school.
- The 'Kiss and Drop' is open between 8.30am and 8.45pm and again between 3:10pm and 3:35pm, which helps a staggered pick-up routine.
- Reversing into car park spaces in the parent car park is prohibited as it significantly disrupts the flow of traffic.
- Turning right into the carpark from the Main North rd. end of Audrey Avenue is a dangerous practice that stops all traffic on Audrey Avenue and causes public cars to take dangerous risks. Please do not turn right into the carpark from Audrey Avenue. This will be a significant aid in speeding up traffic.
- All cars in the parent car park will be impounded (ie can't move them) until 8:45 am in the morning or 3:30 pm in the afternoon to enhance better traffic flow in Audrey Avenue.
- All traffic on the tennis courts will exit via Deakin Street at the direction of the staff on duty. Priority is given to the cars on the driveway to speed up traffic flow.
- 5km/h at all times.
- Please ensure that you meet your child on the same side of the street. Your child should not cross the road without a parent, even with the pedestrian crossing.
- Do not use the gate at the bottom of the kiss and drop driveway for pedestrian access. Please use the school gate at the top of the park.
- To maximize the spaces for car parking on the tennis courts , please park as indicated on the attached map.